

MAGNETICALLY OPERATED OIL LEVEL INDICATOR



FOR TRANSFORMER



MAGNETIC OIL LEVEL INDICATOR - FORM A TO DIN - 42569

FORM A - Oil Level Indicator are used in Distribution transformers upto 5 MVA. It monitors the level of oil in a tank or conservator. The indicator part is kept facing towards atmosphere and has no contact with oil. The indicator part is water tight and does not permit entry of rain water.

Body - Pressure Die Casted Aluminium.

Coating - Powder Coated (Light Grey Shade)

Indicator Dial - Aluminium Sheet coated with black colour and yellow serigraphy or white colour with black serigraphy or any other combination.

Indicator glass may also have serigraphy for oil level.

Pointer - Brass Yellow or Red paint in different designs.

Indicator Glass - Polycarbonate Sheet (U.V. Resistant) gasketed for water tightness.

Gasket for Mounting - Nitrile Rubber hardness 70 Shore A.

Float - Oil resistant, closed cellular type special plastic foam "Nitrophyll" (Red or black colour).

Float arm is supplied as 308 mm standard length. This length can be freely adjusted by the customer during installation from Min 88 mm upto 308 mm.

OPERATIONAL PRINCIPLE

With rise of oil level the float rises radially and its movement is transmitted to the pointer through a set of pair of permanent magnets. The driver magnet available on the float lever mechanism drives the driven polarized indicator magnet. On this magnet the pointer is firmly secured which indicates on the dial the corresponding oil level of vessel.

KSS-A

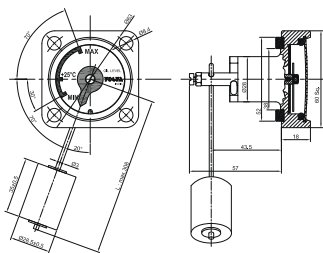

Code : 500101

KSS-B

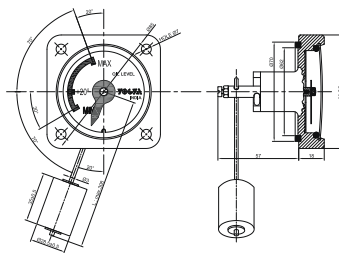

Code : 500102

KSS-F

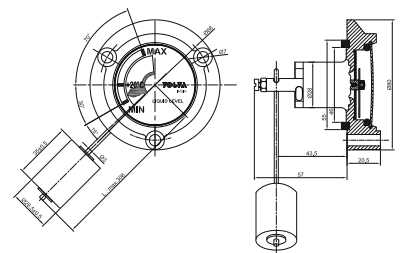

Code : 500103

KSS-G



Code : 500104

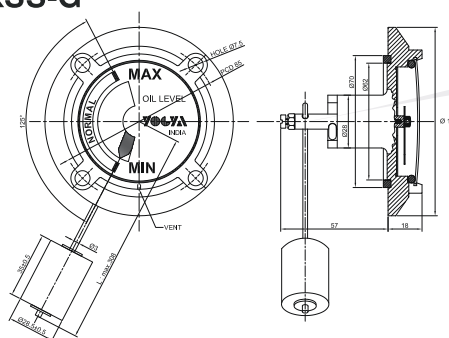

INSTALLATION DETAILS

Float Arm Length (L)	88	120	152	190	245	308
Conservator Tank Diameter	(D) 160	200	250	315	400	500
Essentric Deviation	(E) 25	40	60	90	130	160
Installation Height	(H) 75	88	107	130	160	200

MODEL : SO-4, Dial Size-100 mm (4")



Code : 500105

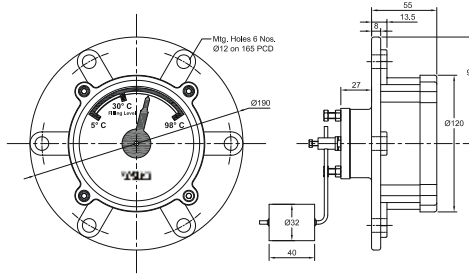

WITHOUT GEAR & SWITCH

Model SO-4 is ideal for use upto 300 DIA conservators of distribution transformers & OLTC. These are available in three designs –

WITHOUT GEAR AND SWITCH

These indicators have bush arrangement for movement of float on its axis. The movement is radially transmitted on the dial. The dial spread is 160°C.



Code : 500106

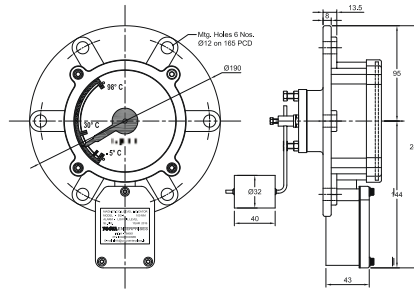

WITHOUT GEAR BUT WITH SWITCH

WITHOUT GEAR BUT WITH SWITCH

These indicators too have bush arrangement. Provision of switch for alarm annunciation is made. Terminal box is also available for termination / connection of leads.



Code : 500107

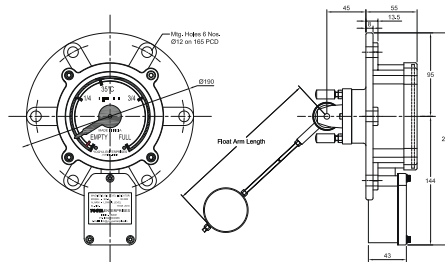

WITH GEAR & SWITCH

WITH GEAR AND SWITCHES

These indicators have switch arrangement. The movement of float and arm is perpendicular to mounting and through a pair of bevel and pinion gear. The gearing enlarges the dial spread to 300 degrees. The switch operates during low level approach.

MODEL : SO-6, Dial Size – 150 mm (6")



Code : 500108

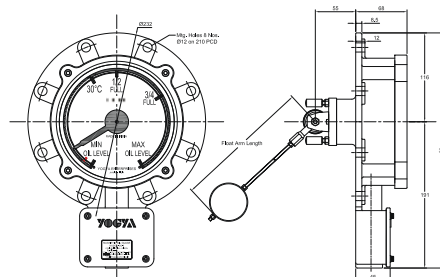

CONVENTIONAL

CONVENTIONAL

Generally SO-6 MOG are used on medium power transformers. They are geared and have provision of low oil level alarm switch and on request high oil level alarm switch. Mounting may be straight or inclined for easy viewing.



Code : 500109

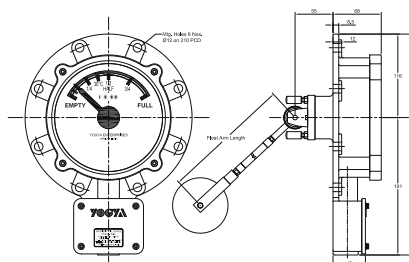

AIR CELL

AIR CELL

These MOG are used together with Air Cell equipped conservator. During ordering care to be taken to mention the mounting details, dial marking and corresponding oil levels.

MODEL : SO-10, Dial Size – 250 mm (10")



Code : 500110

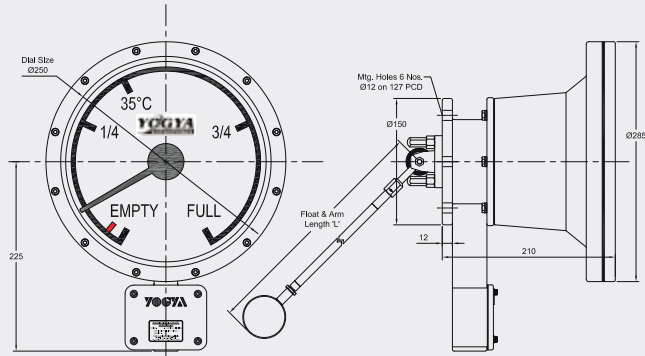

CONVENTIONAL

Straight or Inclined
Mounting



Code : 500111

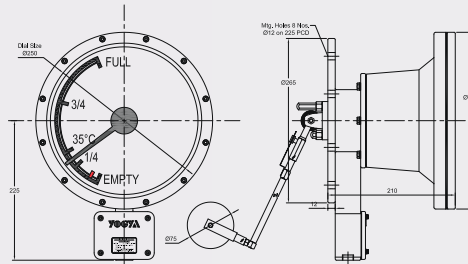

Inclined Mounting

AIR CELL

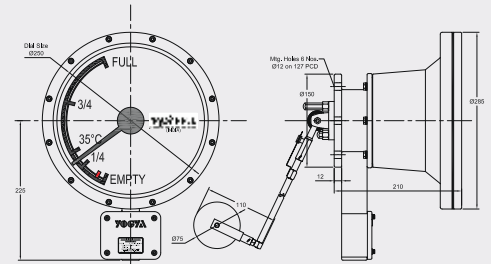

Code : 500112

Straight Mounting

CONVENTIONAL

Such indicators are used on power transformer with conservator above 500 dia. These indicators are used to indicate continuously the level of oil in a conservator. The design is robust & suitable for outdoor application.

AIR CELL

When Air Cell is used in conservator the oil level indicator has to be suitable for this application. The traverse of its arm is 45°. A special float with extended arm length remains below the Air Cell. Due to this reason the dial spread is 160 degrees. It can be mounted straight or inclined. There are two choices of dial markings.

IMPORTANT

- Each instrument is tested to real fitment details provided by customer. Before fitment on transformer co-relate your required parameters with test certificate issued against it.
- Float and Arm are delicate items. Handle them with care.

REQUEST : Before ordering fill in our questionnaire with your required parameters and forward it to us.

TESTS & INSPECTIONS CONDUCTED ON MOG

- The float tested in hot transformer oil for leakproofness.
- The instrument calibrated for its performance with different levels of oil and its corresponding serigraphy on dial.
- HV Test
- Insulation Resistance.
- Water resistant test by dipping in water.
- Pressure test of body to check leakproofness from conservator end.

OUR OTHER PRODUCTS :

- PRISMATIC AND KENYA TYPE OIL LEVEL INDICATOR
- GAS AND OIL OPERATED BUCHHOLZ RELAY
- GAS COLLECTING DEVICE
- SILICAGEL BREATHING
- PRESSURE RELIEF VALVE
- OIL SURGE RELAY

YOGYA
ENTERPRISES
(AN ISO 9001 : 2000 CERTIFIED COMPANY)

YOGYA ENTERPRISES

284 003, In Front of A Cabin, AC Loco Shed Road, Mahaveeranpura,
Uttar Pradesh, Jhansi, India. Ph. : +919415030985. e-mail : info@yogyaenterprises.in